

Quick Tips

Don'ts

- ✗ Make sure the device is NOT leaning forward or backward.

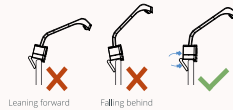

- ✗ Don't leave the wires hanging in front of the Tutor Plus device and blocking the view for the touch sensor.



- ✗ Don't shake the panel or the device after installation.

- ✗ Don't touch the camera fitted in the device.

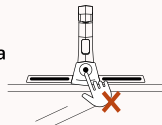

- ✗ Don't forget to check if the red light is glowing after pressing the tip of the stylus. This indicates stylus is charged.



Do's

- ✓ Please read the QSG carefully before installation.

- ✓ Remove the transparent polythene sheet before installing the device.

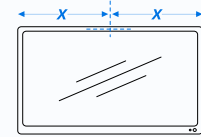

- ✓ Place the Tutor Plus device exactly at the centre of the display / TV.

- ✓ We recommend you use Tutor Plus on a wall mounted TV setup.

If your TV setup on the wall is shaking while writing then, you can use the foam from Tutor Plus box, cut it in 2 halves and place it on either side to fill the gap between TV and Wall.

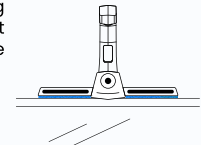

- ✓ Make sure the wires are neatly tied.

- ✓ Please charge the stylus for 3 minutes before using it first time.

- ✓ Make sure to download EyeRIS driver for interactivity & Kneura Teach whiteboard software for teaching and recording lesson.

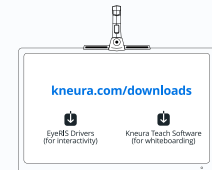

- ✓ Please check for proper internet connectivity while performing the initial set up and product registration.